

## Statement from Amy Butzki - Resident Liaison Officer at Claremont Place

Dear Residents and Leaseholders,

We are pleased to inform you that Starfish Construction has been appointed to carry out the works at **Claremont Place**. Please find below the latest updates regarding the reinstatement works and onsite activities scheduled for the week ending **Friday 13<sup>th</sup> February 2026**.

### News & Updates



### Health & Safety

- No H&S issues to raise over the last week.



Should you have any questions about the works, please don't hesitate to contact Amy Butzki - Resident Liaison Officer via email on [Abutzki@starfishltd.com](mailto:Abutzki@starfishltd.com) or via telephone on **07539011441**.

## Design

- All design has been issued.

## Procurement

- **Render Order has been placed.**
- **A.** 100% of all render material has been delivered.
- **Terracotta Order has been placed.**
- **A.** Brackets & fixings have been delivered on 20.01.2026.
- **B.** Rails are due for delivery W/C 18.02.2026.
- **C.** Tiles are due for delivery at the end of Feb.
- **Cedral cladding has been delivered.**
- Brackets & rails for Cedral are due for delivery 13.02.2026

## Production

- The delays caused by the Spanbrook license on Elevation 2 has caused a 6-week delay to this elevation overall (**Starfish have increased labour to bring the programme back in line, Programme updated**).

### **Elevation 3:**

- EPDM & breather membrane is 100% complete.
- Helping hand brackets for terracotta are 100% installed.
- Render insulation & base coat are 50% complete.

### **Elevation 4:**

- EPDM & breather membrane is 100% complete.
- Helping hand brackets for terracotta are 100% installed.
- Render insulation has been installed along with base coat & starter tracks.

### **Elevation 1:**

- Helping hand brackets for terracotta are 100% installed.
- EPDM & breather membrane is 100% complete.
- Render has commenced.
- Timber cladding replacement sheathing board is complete.

### **Elevation 2:**

- EPDM & breather membrane is 100% complete.
- Render Insulation install is 100% complete.



- Render base is complete
- Render 2nd Coat and primer is underway
- Timber cladding replacement sheathing board is complete

### Resident Update's

- QR Codes for residents have been distributed around the building.
- Resident hub has been updated.

### Resident Issues @ Claremont Place

- No current issues reported.

### Resident Issues @ Spanbrook

- No concerns raised this week.

### Planning & Programming next week

#### **Elevation 3:**

- Commence install rails to terracotta areas
- Commence install of Cedral backing structure
- Complete render

#### **Elevation 4:**

- Commence fire barrier & insulation to terracotta
- Complete render install

#### **Elevation 2:**

- Commence install of Cedral backing structure
- Complete render install



## Claremont Place - Feedback & WhatsApp Group QR code

Thank you for your continued support. By attending these Coffee Mornings, you help us gain valuable insight into making **Claremont Place** an even better community. We look forward to hosting more events in the future! To keep all residents fully updated throughout the duration of the works, we've launched a dedicated **WhatsApp group** exclusively for **Claremont Place**.



This group offers a fast, convenient way to receive:

- 📣 Important announcements and schedule changes
- 🕒 Invitations to resident events like our monthly coffee mornings
- 🔔 Reminders and site activity notices

It's also a great space to ask questions, share feedback, and stay connected with your **Resident Liaison Officer**, and the wider team.

## PHOTOGRAPHIC EVIDENCE

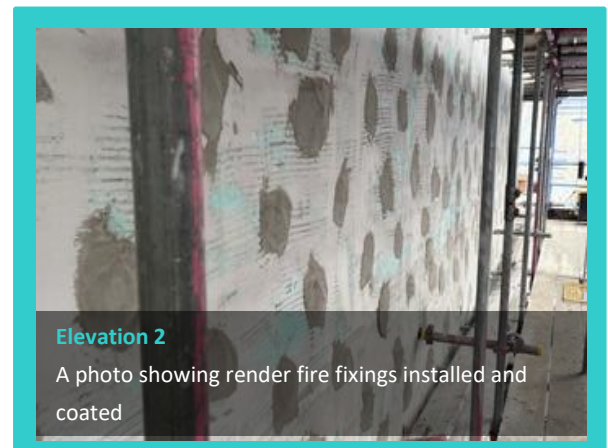
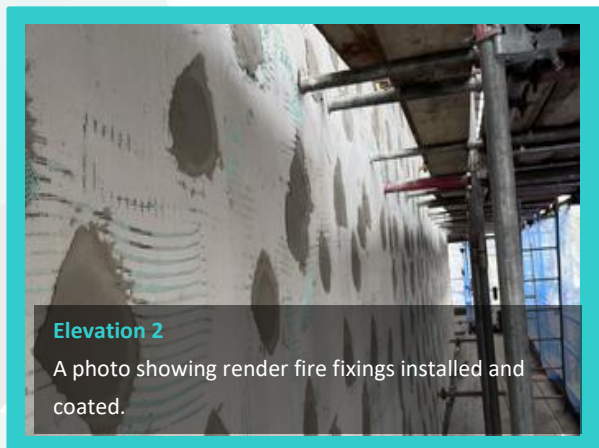

Should you have any questions about the works, please don't hesitate to contact Amy Butzki - Resident Liaison Officer via email on [Abutzki@starfishltd.com](mailto:Abutzki@starfishltd.com) or via telephone on **07539011441**.

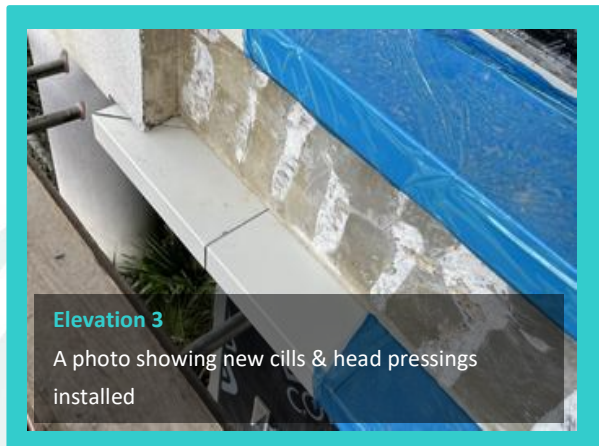
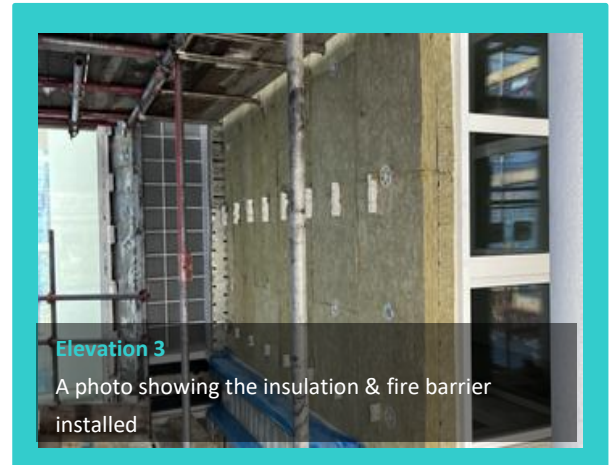
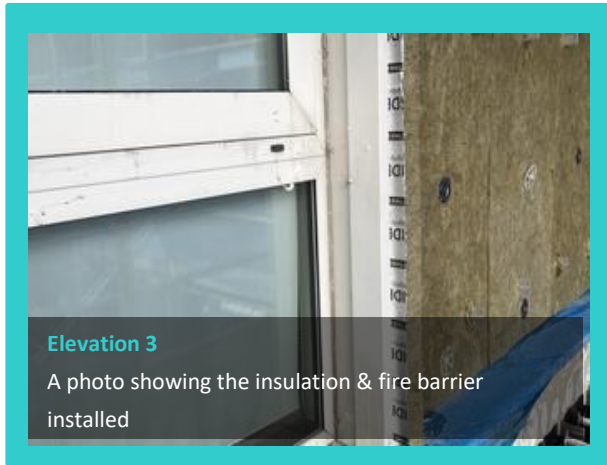

If you have any questions or concerns regarding the ongoing works, please don't hesitate to contact your Resident Liaison Officer, Amy Butzki using the details provided below. Your continued cooperation and support are greatly appreciated as we work to deliver these improvements safely.

## Newsletters & QR Codes

- Newsletters will be issued monthly, with the latest edition scheduled for release in **February 2026**, This will include the most recent updates and news regarding the ongoing works around **Claremont Place**.
- QR Codes have been placed around **Claremont Place**. They have also been posted to each individual resident, simply scan these codes with your phone camera or tablet to access weekly updates via the project hub.



Should you have any questions about the works, please don't hesitate to contact Amy Butzki - Resident Liaison Officer via email on [Abutzki@starfishltd.com](mailto:Abutzki@starfishltd.com) or via telephone on **07539011441**.



- If you have not yet received a copy of the newsletter or the QR code, please contact your Resident Liaison Officer, Amy Butzki, at [abutzki@starfishltd.com](mailto:abutzki@starfishltd.com), who will be happy to send you a copy of the previous edition.
- If you have any questions or concerns please feel free to contact one of our staff members who will be happy to help you. Please see details below.

---

## Contact Information



**Resident Liaison Officer**

Name: Amy Butzki

Telephone: 07539011441

Email: [abutzki@starfishltd.com](mailto:abutzki@starfishltd.com)

Working hours: 9am-4:30pm



**Site Manager**

Name: Geanina Rusu

Telephone: 07983356770

Email: [grusu@starfishconstruction.com](mailto:grusu@starfishconstruction.com)

Working hours: 8am-4:30pm



**Project Manager**

Name: Stuart Sage

Telephone: 07908461775

Email: [ssage@starfishltd.com](mailto:ssage@starfishltd.com)

Working hours: 8am-4:30pm



Should you have any questions about the works, please don't hesitate to contact Amy Butzki - Resident Liaison Officer via email on [Abutzki@starfishltd.com](mailto:Abutzki@starfishltd.com) or via telephone on **07539011441**.